



**Washington State
Department of Transportation**
Duane Berentson
Secretary of Transportation

District 5
2809 Rudkin Road, Union Gap
P.O. Box 12560
Yakima, WA 98909-2560

(509) 575-2510



July 7, 1993

Kittitas County Planning Dept.
Attn: Mark R. Carey, Director
205 W. 5th, Room 182 Courthouse
Ellensburg, WA. 98926

SUBJECT: SEPA Addendum To Existing Environmental Document
DNS and EC for Quarry Site, QS-S-234, Kittitas County

In accordance with State Environmental Policy Act (SEPA) regulations WAC197-11-625, transmitted for your review and comments is a SEPA Addendum To Existing Environmental Document that was prepared by the Washington State Department of Transportation (WSDOT) for the subject project. SEPA regulations require this document be circulated to agencies with jurisdiction.

This document proposes to update the existing SEPA DNS and EC prepared in November 1982 to cover temporary and intermittent operations of an existing rock quarry site for the mining, production and processing, and stockpiling of mineral aggregates for state highway construction and maintenance in the area. Production and processing of mineral aggregates requires that temporary crushers and asphalt and concrete plants be placed and set up in the site. The existing quarry site is located approximately nine miles north of Yakima and a half mile west of Interstate 82, MP 17.3, in Kittitas County; SE1/4, Sec24, T15N, R19E, WM.

Please submit written comments on the addendum no later than July 23, 1993. After the review period has elapsed, all comments received will be evaluated and the addendum will be retained, modified, or withdrawn as required by SEPA regulations.

If you need further information or have any questions, contact Gary Beeman, District 5 Environmental; (509) 575-2544, or Arnie Korynta, District 5 Materials Engineer, (509) 575-2528.

Sincerely,

RICHARD L. LARSON, P.E.
District Administrator

BY: Rodney D. Johnson, P.E.
District Project Development Engineer

GRB
Attach.

**STATE ENVIRONMENTAL POLICY ACT (SEPA)
ADDENDUM TO EXISTING ENVIRONMENTAL DOCUMENT**

Addendum to (check appropriate box): DNS EIS other:

Name of current proposal: Quarry Site, QS-S-234, Kittitas County

Description of current proposal: Temporary and intermittent operation of an existing rock quarry site for the mining, production and processing, and stockpiling of mineral aggregates for state highway construction and maintenance in the area. Production and processing of mineral aggregates requires that temporary crushers and asphalt and concrete plants be placed and set up in the site.

Proponent: Washington State Department of Transportation, District 5

Location of current proposal: The existing quarry site is located approximately nine miles north of Yakima and a half mile west of Interstate 82, MP 17.3, in Kittitas County; SE1/4, Sec24, T15N, R19E, WM.

Title of document being addended: SEPA Determination of Nonsignificance (DNS) and Environmental Checklist (EC), Quarry Site, QS-S-234, Kittitas County

Agency that prepared document being addended: Washington State Department of Transportation, District 5

Date addended document was prepared: November 1982

Description of document (or portion) being addended: SEPA DNS and EC completed for the indicated quarry site in Kittitas County.

If the document being addended has been challenged (197-11-630), please describe: None.

The document is available to be read at (place/time): Washington State Department of Transportation, District 5 Headquarters Office, 2809 Rudkin Road, Union Gap, WA. 98903 - 8:00 am to 4:00 pm, Monday to Friday.

We have identified and Addended this document as being appropriate for this proposal after independent review. The document meets our environmental review needs for the current proposal and will accompany the proposal to the decisionmaker.

Name of agency adopting document: Washington State Department of Transportation, District 5

Contact person, if other than responsible official: Gary R. Beeman, District 5 Environmental

Phone: (509) 575-2544

Responsible official: RICHARD L. LARSON, P.E.

Position/title: District Administrator

Phone: (509) 575-2516

Address: Washington State Department of Transportation, District 5,
P.O. Box 12560, Yakima, WA. 98909-2560

Date: 7-7-93

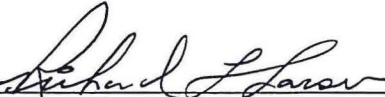
Signature: 

TRAILER NO.	STATE	PER. AND PROJECT NO.	SHEET NO.
8	WASH		

NOTES

1. QUARRY SITE Q5-S-234 IS LOCATED 1/2 MILE WEST OF 1-82 APPROXIMATELY 9 MILES NORTH OF YAKIMA IN KITTITAS COUNTY.
2. QUARRY IS LOCATED ON OPEN, UNDEVELOPED RANGELAND. PRINCIPAL COVER IS SAGEBRUSH, GREASEWOOD AND DESERT GRASSES. THE ADJACENT TERRAIN TO THE NORTH, SOUTH, EAST AND WEST IS ROLLING WITH MODERATE TO STEEP SLOPES.
3. THE NATURAL DRAINAGE PATTERN OF ADJACENT AREAS WILL NOT BE DISTURBED.
4. THE NATURAL TERRAIN IS NOT SUFFICIENT TO ENTIRELY BLOCK THE PUBLIC VIEW OF THE QUARRY FROM 1-82.
5. THIS QUARRY WILL PRODUCE NO CONTAMINANTS AND THERE ARE NO STREAMS REQUIRING CONTAMINANT CONTROL.
6. THIS QUARRY WILL NOT CREATE ANY BODIES OF WATER OR OTHER TOPOGRAPHICAL FEATURE WHICH WOULD BE BENEFICIAL FOR RECREATIONAL, GAME OR WILDLIFE PURPOSES.

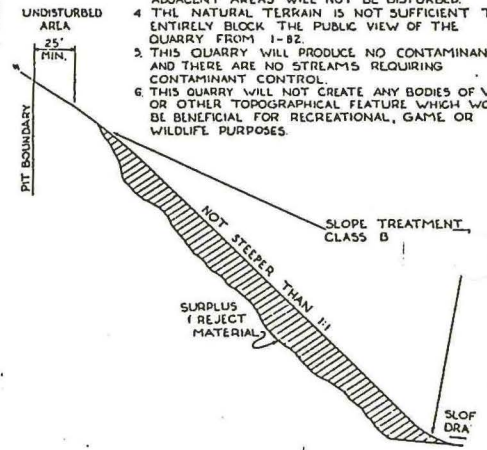

SECTION A - A

7. ALL DISTURBED AREAS THAT WILL SUPPORT GROWTH WILL BE SEED FERTILIZED (100% CRESTED WHEAT).
8. APPROXIMATELY 400,000 CU.YDS. OF MATERIAL WILL BE REMOVED ON FIRST STAGE FOR USE ON 1-82.
9. STRIPPINGS WILL BE STOCKPILED FOR EVENTUAL REPLACEMENT THE QUARRY AREA. PAVING AGGREGATE MATERIAL WILL BE STOCKPILED IN THE INDICATED AREA TO BE WORKED.
10. THE HAUL ROAD WILL BE OBLITERATED UPON TOTAL DEPLETION OF OPERATIONS.
11. KITTITAS COUNTY ZONES ALL LAND IN THE SUBJECT AREA AS UNCLAS.
12. NO ADDITIONAL DEVELOPMENT OF THIS SITE WITHIN TWO YEARS OF DEPLETION OR ABANDONMENT IS ANTICIPATED.

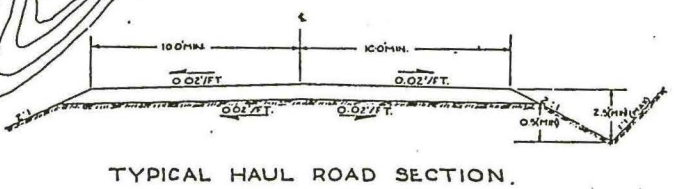
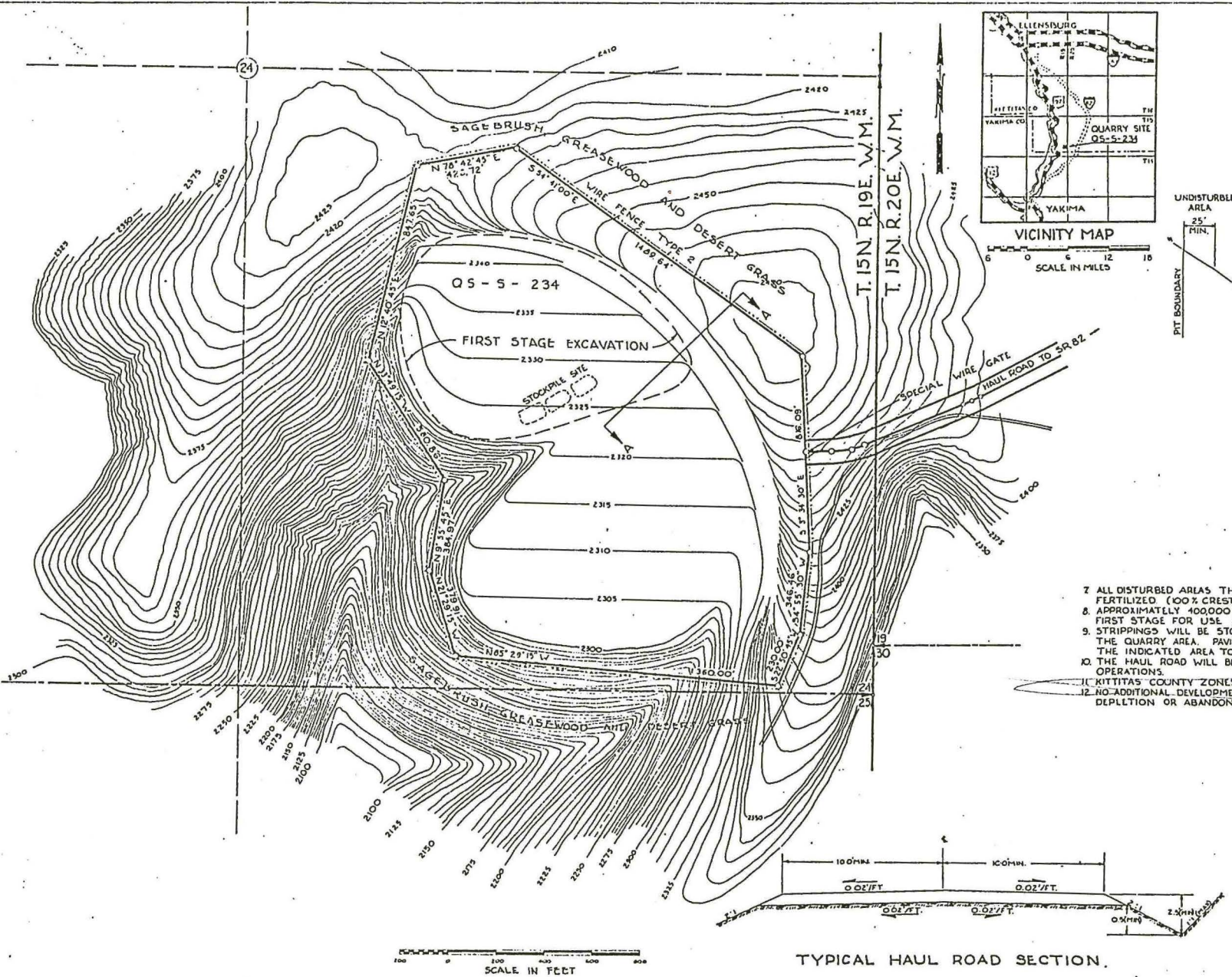

DISTRICT 5
RECLAMATION PLAN
QUARRY SITE QS-S-234

APPROVED *[Signature]*
ROADWAY DEVELOPER

FORM FOR (~~PROPOSED~~/FINAL) DECLARATION
OF (~~SIGNIFICANCE~~/NON-SIGNIFICANCE)

Name of Proposal: Quarry Site, QS-S-234, Kittitas County

Description of Proposal:

Operation of a rock quarry for the production of mineral aggregates for construction and maintenance of state highways.

Approximately 300,000 cubic yards of aggregates are available from this site. The site would also be utilized to stockpile aggregate for use for highway maintenance.

Proponent: Washington State Department of Transportation

Location of Proposal:

The site is located in the Southeast $\frac{1}{4}$ of Section 24, Township 15 North, Range 19 East, Willamette Meridian, 9 miles north of Yakima in Kittitas County. The site is approximately $\frac{1}{2}$ mile west of Interstate Highway 82.

Lead Agency: Washington State Department of Transportation

This proposal has been determined to (~~have~~/not have) a significant adverse impact upon the environment. An EIS (~~is~~/is not) required under RCW 43.21C.-030(2)(c). This decision was made after review of a completed environmental checklist and other information on file with the Department of Transportation.

Responsible Official: R. C. Schuster

Position/Title: ~~Location-Design Engineer~~ District Administrator

Date: 11-8-82

Signature: Robert Schuster

ENVIRONMENTAL CHECKLIST

I. BACKGROUND

1. Name of Proponent: Washington State Department of Transportation

2. Address and Phone Number of Proponent:

Highway Administration Building	Department of Transportation
Olympia, Washington 98504	P.O. Box 52
	Yakima, WA 98907
Phone: Area Code 206-753-6155	(509)575-2544

3. Date Checklist Submitted: November 1, 1982

4. Agency Requiring Checklist: Washington State Department of Transportation

5. Name of Proposal, if Applicable:

Quarry Site, QS-S-234, Kittitas County

6. Nature and Brief Description of the Proposal (including, but not limited to its size, general design elements, and other factors that will give an accurate understanding of its scope and nature:

Operation of a rock quarry for the production of mineral aggregate for construction and maintenance of State highway. Approximately 300,000 cubic yards of aggregate are available from this site. The site would also be used to stockpile aggregate for use to maintain state highways.

7. Location of Proposal (describe the physical setting of the proposal, as well as the extent of the land area affected by any environmental impacts, including any other information needed to give an accurate understanding of the environmental setting of the proposal):

The site is located 9 miles north of Yakima, $\frac{1}{2}$ mile west of Interstate Highway 82, in the Southeast $\frac{1}{4}$ of Section 24, Township 15 North, Range 19 East, Willamette Meridian in Kittitas County. The surrounding area is rolling hills with moderate to steep slopes covered by sagebrush and dryland grasses, and used primarily as open range.

8. Estimated Date for Completion of the Proposed Action: 2030

9. List of All Permits, Licenses or Government Approvals Required for the Proposal (federal, state and local--including rezones):

Surface Mining Operating Permit - WA. Dept of Natural Resources.

for asphalt plant (temp.?) need CUP
for concrete need ? CUP in GI zone

10. Do you have any plans for future additions, expansion, or further activity related to or connected with this proposal? If yes, explain:

No.

11. Do you know of any plans by others which may affect the property covered by your proposal? If yes, explain:

No.

12. Attach any other application form that has been completed regarding the proposal; if none has been completed, but is expected to be filed at some future date, describe the nature of such application form:

This site has an existing Department of Natural Resources Operating Permit number 10054.

II. ENVIRONMENTAL IMPACTS

(Explanations of all "yes" and "maybe" answers are required.)

	<u>YES</u>	<u>MAYBE</u>	<u>NO</u>
(1) <u>Earth</u> . Will the proposal result in:			
(a) Unstable earth conditions or in changes in geologic substructures?	___	___	<u>X</u>
(b) Disruptions, displacements, compaction or overcovering of the soil?	<u>X</u>	___	___
(c) Change in topography or ground surface relief features?	<u>X</u>	___	___
(d) The destruction, covering or modification of any unique geologic or physical features?	___	___	<u>X</u>
(e) Any increase in wind or water erosion of soils, either on or off the site?	<u>X</u>	___	___
(f) Changes in deposition or erosion of beach sands, or changes in siltation, deposition or erosion which may modify the channel of a river or stream or the bed of the ocean or any bay, inlet or lake?	___	___	<u>X</u>

Explanation: (a&b) The proposal would excavate and remove mineral aggregates from the site, disturbing and displacing soil and altering existing topography and surface relief features. Strippings would be distributed over the quarry once mining operations are completed. Final reclamation would be in accordance with an approved reclamation plan. (e) Disruption of rock would temporarily increase erosion potential. Once work is completed, the site would be seeded with perennial grasses to minimize erosion.

(2) Air. Will the proposal result in:

(a) Air emissions or deterioration of ambient air quality?	<u>X</u>	___	___
(b) The creation of objectionable odors?	___	<u>X</u>	___
(c) Alteration of air movement, moisture or temperature, or any change in climate, either locally or regionally?	___	___	<u>X</u>

Explanation:

(a) Operation of mining, crushing, and asphalt production equipment would produce fumes, dust, and airborne material temporarily reducing ambient air quality. All work would be subject to and comply with local air quality authority regulations. Once work is completed air quality would return to existing levels.

(b) Emissions from equipment would be considered objectionable by some. This would be a temporary condition and would not exist after work is completed.

	<u>YES</u>	<u>MAYBE</u>	<u>NO</u>
(3) <u>Water</u> . Will the proposal result in:			
(a) Changes in currents, or the course or direction of water movements, in either marine or fresh waters?	___	___	<u>X</u>
(b) Changes in absorption rates, drainage patterns, or the rate and amount of surface water runoff?	<u>X</u>	___	___
(c) Alterations to the course or flow of flood waters?	___	___	<u>X</u>
(d) Change in the amount of surface water in any water body?	___	___	<u>X</u>
(e) Discharge into surface waters, or in any alteration of surface water quality, including but not limited to temperature, dissolved oxygen or turbidity?	___	___	<u>X</u>
(f) Alteration of the direction or rate of flow of ground waters?	___	___	<u>X</u>
(g) Change in the quantity of ground waters, either through direct additions or withdrawals, or through interception of an aquifer by cuts or excavations?	___	___	<u>X</u>
(h) Deterioration in ground water quality, either through direct injection, or through the seepage of leachate, phosphates, detergents, waterborne virus or bacteria, or other substances into the ground waters?	___	___	<u>X</u>
(i) Reduction in the amount of water otherwise available for public water supplies?	___	___	<u>X</u>

Explanation:

(b) Operations within the site could fracture underlying rock and increase absorption rates. Altered topography within the site would change existing drainage patterns slightly.

(4) <u>Flora</u> . Will the proposal result in:			
(a) Change in the diversity of species, or numbers of any species of flora (including trees, shrubs, grass, crops, microflora and aquatic plants)?	<u>X</u>	___	___
(b) Reduction of the numbers of any unique, rare or endangered species of flora?	___	___	<u>X</u>

	<u>YES</u>	<u>MAYBE</u>	<u>NO</u>
(c) Introduction of new species of flora into an area, or in a barrier to the normal replenishment of existing species?	—	<u>X</u>	—
(d) Reduction in acreage of any agricultural crop?	—	—	<u>X</u>

Explanation:

(a) Existing vegetation would be removed from within the work limits of the mining operation.

(c) The site would be seeded with perennial grasses after mining is completed, possibly introducing new species of plant material to the site.

(5) Fauna. Will the proposal result in:

(a) Changes in the diversity of species, or numbers of any species of fauna (birds, land animals, including reptiles, fish and shellfish, benthic organisms, insects or microfauna)?	<u>X</u>	—	—
(b) Reduction of the numbers of any unique, rare or endangered species of fauna?	—	—	<u>X</u>
(c) Introduction of new species of fauna into an area, or result in a barrier to the migration or movement of fauna?	—	—	<u>X</u>
(d) Deterioration to existing fish or wildlife habitat?	<u>X</u>	—	—

Explanation:

(a) Small rodents, mammals, insects, reptiles, and birds are regular inhabitants or frequent visitors to the site. Pit operations would temporarily reduce these populations. Once quarry rock is completed the site would be revegetated and fauna would again occupy the site.

(b) Temporary deterioration of existing habitat would be experienced during construction.

(6) Noise. Will the proposal increase existing noise levels?

<u>X</u>	—	—
----------	---	---

Explanation:

Operation of mining, crushing, and asphalt production equipment, and periodic blasting would increase noise levels temporarily. Once work is completed noise levels would return to present levels. There are no existing residences or other noise sensitized sites within the immediate area of this site.

	<u>YES</u>	<u>MAYBE</u>	<u>NO</u>
(7) <u>Light and Glare.</u> Will the proposal produce new light or glare?	—	—	<u>X</u>

Explanation:

(8) <u>Land Use.</u> Will the proposal result in the alteration of the present or planned land use of an area?	—	—	<u>X</u>
--	---	---	----------

Explanation:

The site presently owned by the Washington State Department of Transportation for the purpose of mining and stockpiling mineral aggregate.

(9) <u>Natural Resources.</u> Will the proposal result in:			
(a) Increase in the rate of use of any natural resource?	—	—	<u>X</u>
(b) Depletion of any nonrenewable natural resource?	<u>X</u>	—	—

Explanation:

This proposal would remove approximately 300,000 cubic yards of mineral aggregates from this site, and deplete the resource by that amount. This would not be considered a significant depletion of natural resource.

(10) <u>Risk of Upset.</u> Does the proposal involve a risk of an explosion or the release of hazardous substances (including, but not limited to, oil, pesticides, chemicals or radiation) in the event of an accident or upset conditions?	—	<u>X</u>	—
--	---	----------	---

Explanation:

Mining and asphalt production would involve use of fuels, oils and blasting materials. Risk of explosions or release of deleterious materials is always a possibility, but standard construction practices required by state contractors would minimize this potential.

	<u>YES</u>	<u>MAYBE</u>	<u>NO</u>
(11) <u>Population</u> . Will the proposal alter the location, distribution, density, or growth rate of the human population of an area?	___	___	<u>X</u>

Explanation:

(12) <u>Housing</u> . Will the proposal affect existing housing or create a demand for additional housing?	___	___	<u>X</u>
--	-----	-----	----------

Explanation:

(13) <u>Transportation/Circulation</u> . Will the proposal result in:			
(a) Generation of additional vehicular movement?	<u>X</u>	___	___
(b) Effects on existing parking facilities, or demand for new parking?	___	___	<u>X</u>
(c) Impact upon existing transportation systems?	___	___	<u>X</u>
(d) Alterations to present patterns of circulation or movement of people and/or goods?	___	___	<u>X</u>
(e) Alterations to waterborne, rail or air traffic?	___	___	<u>X</u>
(f) Increase in traffic hazards to motor vehicles, bicyclists or pedestrians?	___	___	<u>X</u>

Explanation:
(a) Traffic to and from the site would increase during mining operations.

	<u>YES</u>	<u>MAYBE</u>	<u>NO</u>
(14) <u>Public Services.</u> Will the proposal have an effect upon, or result in a need for new governmental services in any of the following areas:			
(a) Fire protection?	___	___	<u>X</u>
(b) Police protection?	___	___	<u>X</u>
(c) Schools?	___	___	<u>X</u>
(d) Parks or other recreational facilities?	___	___	<u>X</u>
(e) Maintenance of public facilities, including roads?	___	___	<u>X</u>
(f) Other governmental services?	___	___	<u>X</u>
Explanation:			

(15) <u>Energy.</u> Will the proposal result in:			
(a) Use of substantial amounts of fuel or energy?	___	___	<u>X</u>
(b) Demand upon existing sources of energy, or require the development of new or altered sources of energy?	___	___	<u>X</u>
Explanation:			

The amount of energy used during mining operation would not be considered substantial.

(16) <u>Utilities.</u> Will the proposal result in a need for new systems, or alterations to the following utilities?			
(a) Power or natural gas?	___	<u>X</u>	___
(b) Communications systems?	___	___	<u>X</u>
(c) Water?	___	___	<u>X</u>
(d) Sewer or septic tanks?	___	___	<u>X</u>
(e) Storm water drainage?	___	___	<u>X</u>

YES MAYBE NO

(f) Solid waste and disposal? _____ _____ X

Explanation:

(a) Operation of a crusher may require electrical power.

(17) Human Health. Will the proposal result in the creation of any health hazard or potential health hazard (excluding mental health)? _____ _____ X

Explanation:

(18) Aesthetics. Will the proposal result in the obstruction of any scenic vista or view open to the public, or will the proposal result in the creation of an aesthetically offensive site open to public view? _____ _____ X

Explanation:

This site is not visible from any public road.

(19) Recreation. Will the proposal result in an impact upon the quality or quantity of existing recreational opportunities? _____ _____ X

Explanation:

(20) Archaeological/Historical. Will the proposal result in an alteration of a significant archaeological or historical site, structure, object or building? _____ _____ X

Explanation:

No known historical or archaeological resources are located within the site. The Department will request a cultural resources survey be completed by a qualified consultant. Results of this survey will be coordinated with the State Office of Archaeology and Historical Preservation.

III. SIGNATURE

I, the undersigned, state that to the best of my knowledge the above information is true and complete. It is understood that the lead agency may withdraw any declaration of non-significance that it might issue in reliance upon this checklist should there be any willful misrepresentation or lack of full disclosure on my part.

Proponent:

Wm Jordan
Project Planning & Design Engineer
District Location Engineer

Date:

11/5/82